



For FAQs and more information, please visit:

www.eufylife.com



Cleaning

Owner's Manual

RoboVac 20

Table of Contents

01 Important Safety Instructions

03 About Your RoboVac

What's In the Box

RoboVac Anatomy

07 Using Your RoboVac

Install the Charging Base

Charge Your RoboVac

Start/Stop Cleaning

Cleaning Modes

Time Setting

Scheduled Cleaning

Use the Sonic Wall

Charge the Sonic Wall

15 Cleaning and Maintenance

Clean the Dust Collector and Filter

Clean the Rolling Brush

Clean the Sensors and Charging Pins

Clean the Side Brushes

Replace the Side Brushes

18 Additional Information

Remove/Install RoboVac's Battery

Install Additional Charging Base or Sonic Wall

21 Troubleshooting

22 Specifications

23 Notice

23 Customer Service

Important Safety Instructions

To reduce the risk of injury or damage, keep these safety instructions in mind when setting up, using and maintaining this device.



WARNING SYMBOLS USED

This is the safety alert symbol. This symbol alerts you to potential hazards that can result in property damage and/or serious bodily harm or death.

- This device is not intended for use by persons (including children) with reduced physical, sensory or mental capabilities, or lack of experience and knowledge, unless they have been given supervision or instruction concerning use of the device by a person responsible for their safety.
- This device can be used by children aged from 8 years and above and persons with reduced physical, sensory or mental capabilities or lack of experience and knowledge if they have been given supervision or instruction concerning use of the device in a safe way and understand the hazards involved. Children should be supervised to ensure they do not play with the device. Cleaning and maintenance shall not be performed by children without supervision.
- The device is only to be used with the power supply unit provided.
- For the purposes of recharging the battery, only use the detachable supply unit provided with this device.
- The battery must be removed from the device before the device is scrapped.
- The used battery should be placed in a sealed plastic bag and disposed of safely according to local environmental regulations.
- The device must be disconnected from the supply mains when removing the battery. For details on how to remove the battery, please refer to the section "Remove/Install RoboVac's battery" on page 18.
- The external flexible cable or cord of the power supply unit cannot be replaced; if the cord is damaged, the power supply unit shall be scrapped.
- This device is for indoor use only.
- This device is not a toy. Do not sit or stand on this device. Small children and pets should be supervised when this device is operating.
- Store and operate this device in room temperature environments only.
- Clean with a cloth dampened with water only.

- Do not use this device to pick up anything that is burning or smoking.
- Do not use this device to pick up spills of bleach, paint, or other chemicals, or anything wet.
- Before using this device, pick up objects like clothing, loose papers, pull cords for blinds or curtains, power cords, and any fragile objects. If the device passes over a power cord and drags it, there is a chance an object could be pulled off a table or shelf.
- If the room to be cleaned contains a balcony, a physical barrier should be used to prevent access to the balcony and ensure safe operation.
- Do not place anything on top of this device.
- Be aware that the device moves on its own. Take care when walking in the area that the device is operating in to avoid stepping on it.
- Do not operate the device in areas with exposed electrical outlets in the floor.
- Do not expose the electronics of this device, its battery, or the integrated Charging Base. There are no user serviceable parts inside.
- Do not use this device on an unfinished, unsealed, waxed or rugged floor. It may result in damage to the floor and the device.

IMPORTANT TIPS

Check the following items before use:

- Remove carpets that are thicker than 15mm as they may cause it to malfunction.
- This device has been specially designed to be used on the floor surface without scratching it, for safety purpose, we still recommend that you test the device in a small area to see if any scratches left before cleaning the whole room.
- Drop sensors are used to prevent the device from tumbling down stairs and steep drops, they may work less effectively on light reflected surface, deep color floor or when they are dirty. Make sure to use a Sonic Wall or any other physical barriers to block off problem areas where the device may fall.

About Your RoboVac

What's In the Box

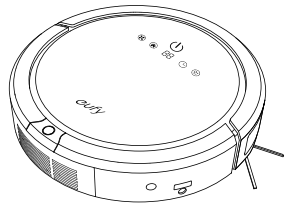

RoboVac

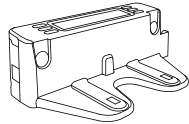

Charging Base

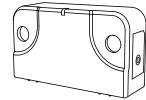

Sonic Wall

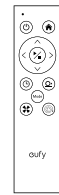

Remote Control

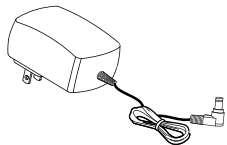

Power Adapter

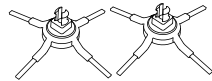

Spare Side Brush (x2)

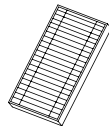

Spare HEPA-style Filter

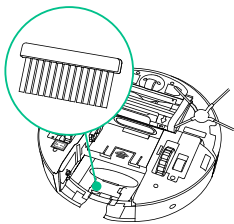

Clean Brush
(Inside RoboVac)



Brush Cleaning Tool
(In the back of the
Charging Base)

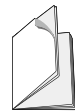



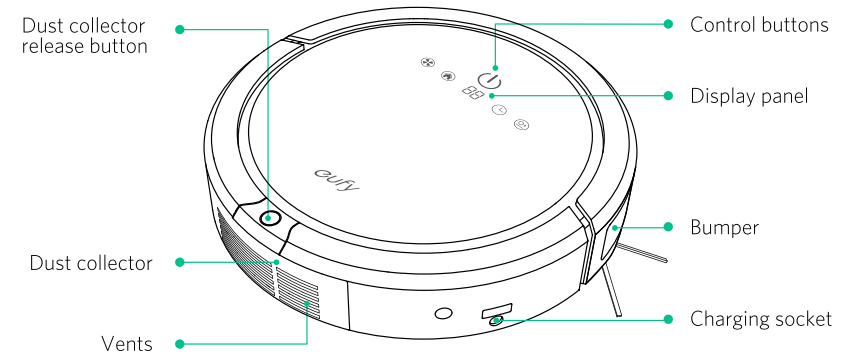

Owner's Manual

RoboVac Anatomy

Top & Side



Control Buttons

-  Press to start/stop cleaning.
-  Press to turn on/off suction fan.
- When turned off, RoboVac cleans quietly with low suction.
-  Press to return RoboVac to the Charging Base.
-  Press to select the cleaning time.
- Select the time based on the calculation of the size of the cleaning area.
-  Press to turn on/off collision avoidance function.
- RoboVac detects and avoids obstacles automatically when this function is turned on.

Display Status Information

Display	Meaning
02/04 ... 18/20	Timer 02 = 20 minutes 04 = 40 minutes ... 18 = 180 minutes 20 = 200 minutes
A/1/2/3/4/5	Cleaning modes A: Automatic cleaning 1: Free cleaning 2: Spot cleaning 3: Edge cleaning 4: Zigzag cleaning 5: Polygon Cleaning
E1/E2 ... E8/E9	Error codes (see Troubleshooting for more details)
H	Returning to the Charging Base
BB	The dust collector needs to be emptied. Turn off RoboVac and empty the dust collector.
[d	RoboVac is in pairing mode.

Bottom

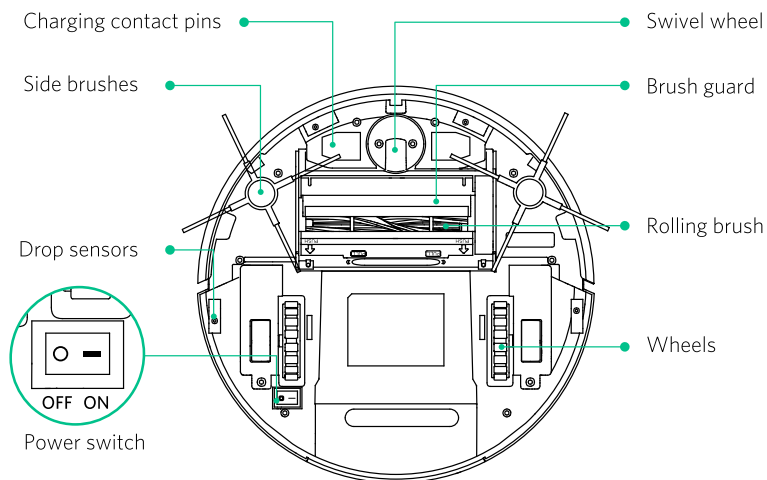

Remote Control

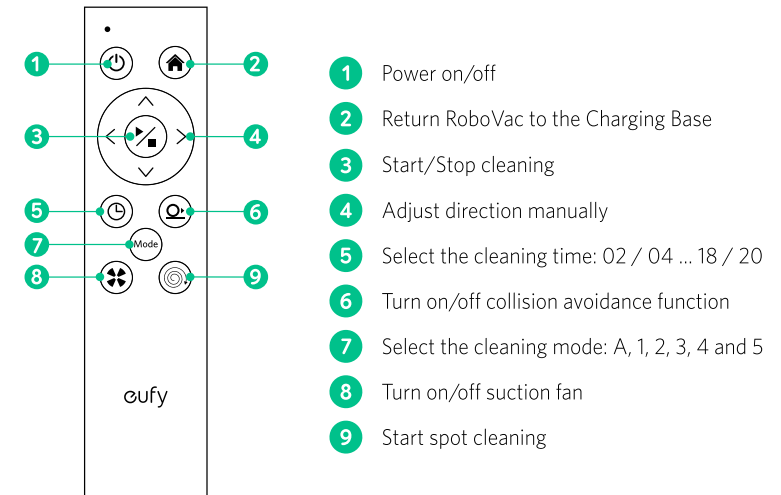

- The remote may not work when RoboVac is near the Sonic Wall.
- Before using your remote for the first time, install 2 AAA batteries.

Charging Base

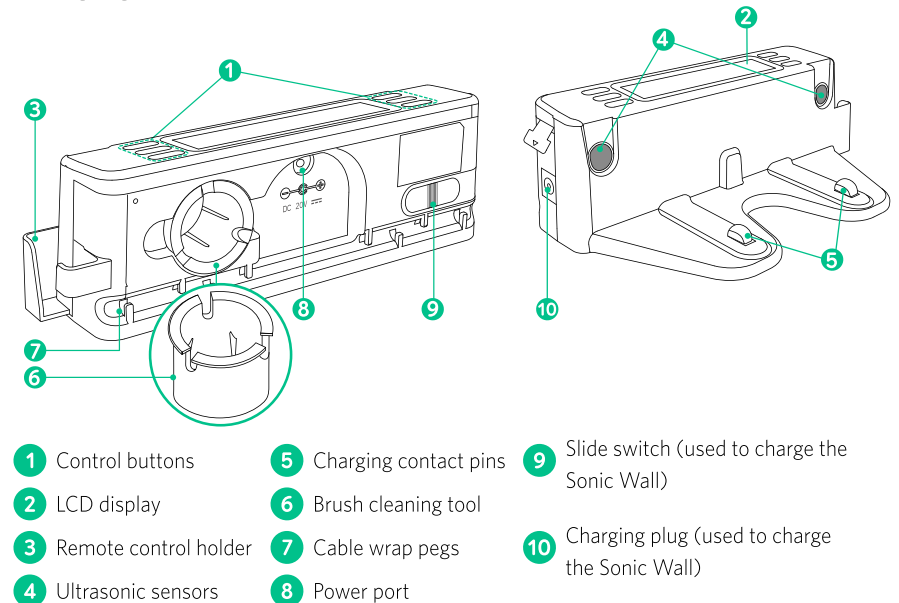

Sonic Wall

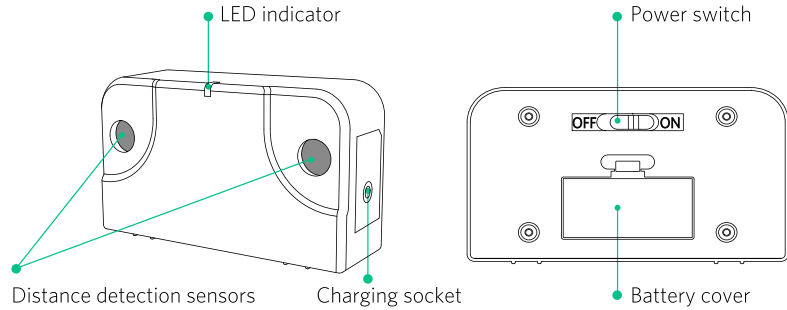

Dust Collector

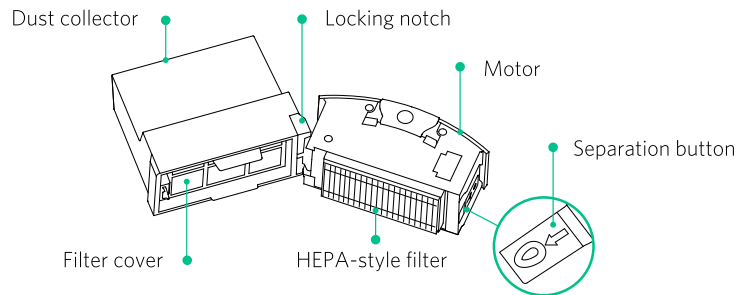

Using Your RoboVac

Install the Charging Base

1. Place the Charging Base against wall on a flat surface.

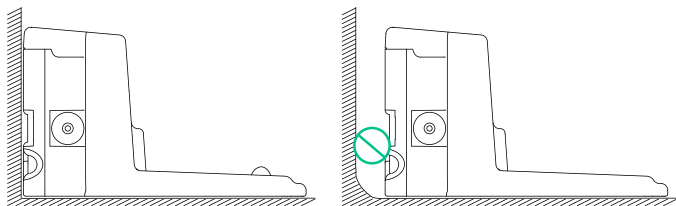

2. Remove objects within 1 m to the left and right side and within 2 m to the front.

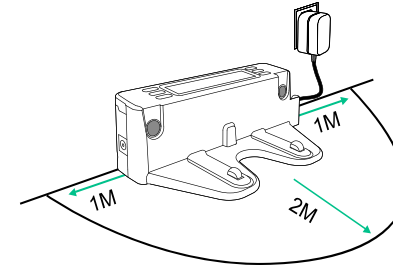

3. Connect the round connector of the adapter into the power port on the Charging Base and the other end into a wall outlet.

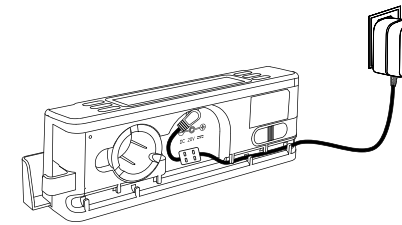

- Install the Charging Base in a location that can be easily accessed by your RoboVac.
- Always keep the Charging Base plugged in, otherwise RoboVac will not automatically return.

Charge Your RoboVac

RoboVac has a pre-installed rechargeable battery that has to be fully charged before use.

Robovac returns to the Charging Base at the end of a cleaning cycle or when its battery is running low.

Manually charge RoboVac when its battery is fully discharged or when it fails to reach the Charging Base.

Method 1: Attach RoboVac to the Charging Base by aligning the charging pins of it with the charging pins on the base.

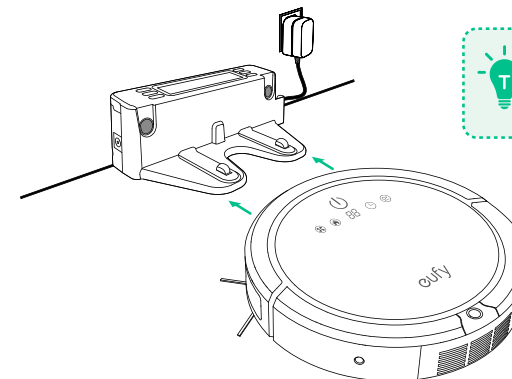

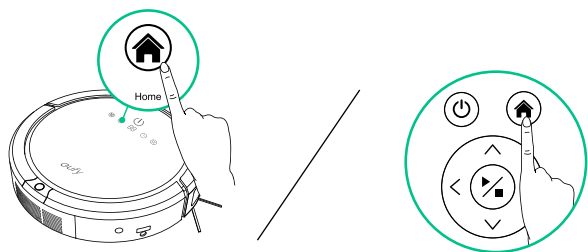

- When RoboVac is fully charged, "Full" will be displayed on the LCD display panel.

Method 2: Press  on RoboVac or on the remote control to return RoboVac to the Charging Base.

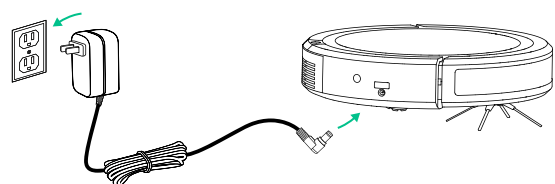

Method 3: Charge RoboVac directly by plugging the round connector of the adapter into the power port on RoboVac and the other end into a wall outlet.





Indicator on RoboVac		
	Flashing red	Low power
	Flashing blue	Standby / Charging
	Steady blue	Fully charged / Cleaning

Start/Stop Cleaning

1. Turn the main power supply on

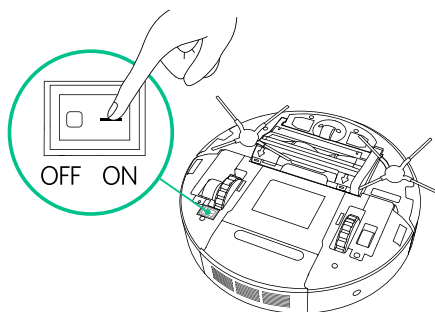
Press the power switch on the bottom of RoboVac to turn on the main power supply.





 Turn off the power switch if RoboVac will not be used for a long period of time.

2. Turn the power on

Press  on RoboVac or on the remote control to turn the power on.

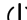
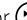
3. Start cleaning

- Press  on RoboVac or  on the remote control to start cleaning in Auto mode.
- Press  on the remote control to start cleaning in Spot mode.
- Press **start** on the Charging Base to instruct RoboVac to commence cleaning when fully charged.
- Press and hold **start** on the Charging Base for 3 seconds to instruct RoboVac to start cleaning immediately.

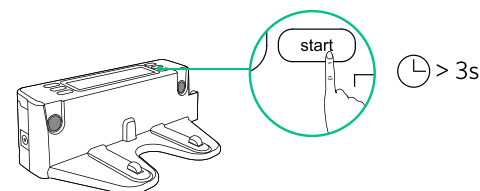

4. Stop cleaning

Press  on RoboVac or  on the remote control to stop cleaning.

Cleaning Modes

1. Auto cleaning

RoboVac calculates the room size and optimizes its path by selecting different cleaning modes automatically until cleaning is complete.

Press the Mode button repeatedly until "A" appears on the display panel.

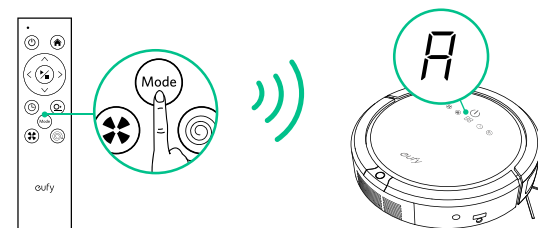

- RoboVac will return to the Charging Base automatically when the power level becomes low.
- Whenever you turn RoboVac on, it will start auto cleaning.

2. Free cleaning

RoboVac cleans until it hits an obstacle and then moves off in a random direction.

Press the Mode button repeatedly until "1" appears on the display panel.

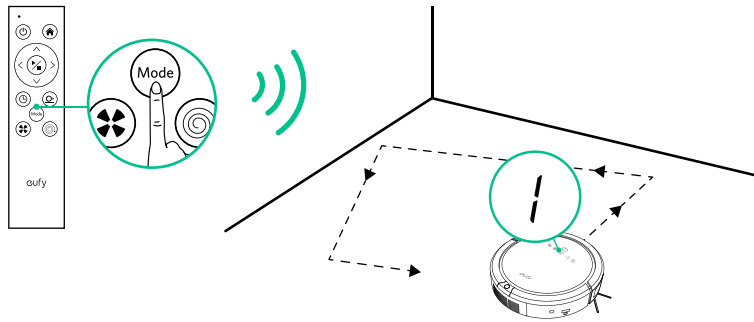

3. Spot cleaning

RoboVac intensely cleans a specific area in a spiral pattern. Useful if there is a concentrated area of dust or debris.

Press the Mode button repeatedly until "2" appears on the display panel or press .

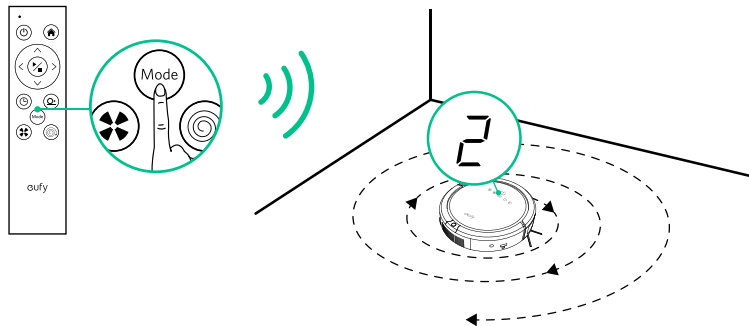

4. Edge cleaning

RoboVac reduces its speed when it detects a wall to ensure the edge is cleaned thoroughly.

Press the Mode button repeatedly until "3" appears on the display panel.

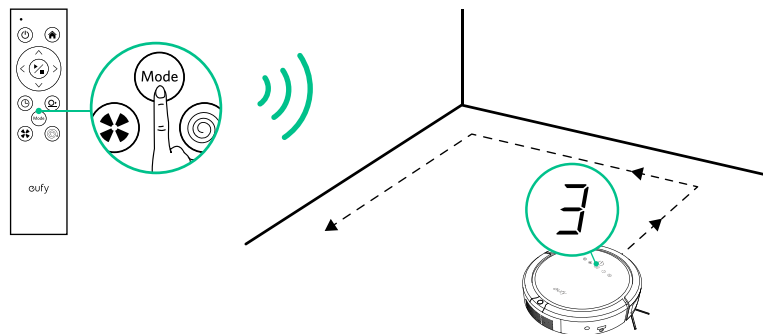

5. Zigzag cleaning

RoboVac repeats a zigzag pattern to clean each spot in the cleaning area.

Press the Mode button repeatedly until "4" appears on the display panel.

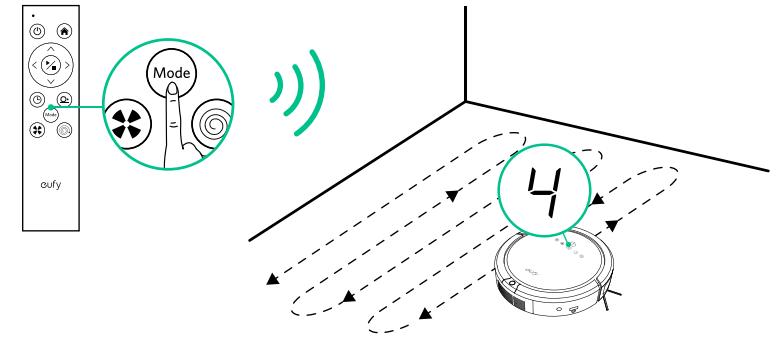

6. Polygon cleaning

RoboVac repeats a polygonal pattern to clean each spot in the cleaning area.

Press the Mode button repeatedly until "5" appears on the display panel.

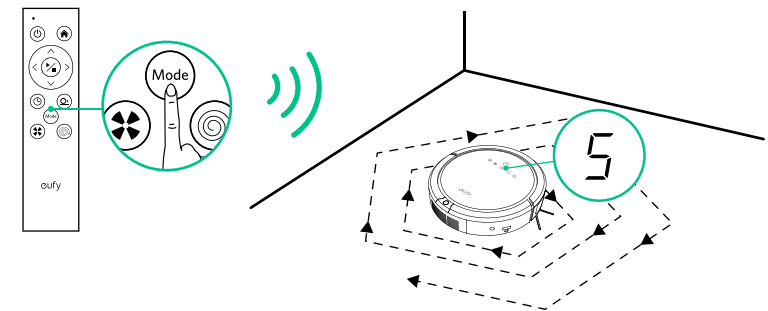

7. Manual cleaning

You can instruct RoboVac to clean a particular location by using the directional buttons on the remote control.

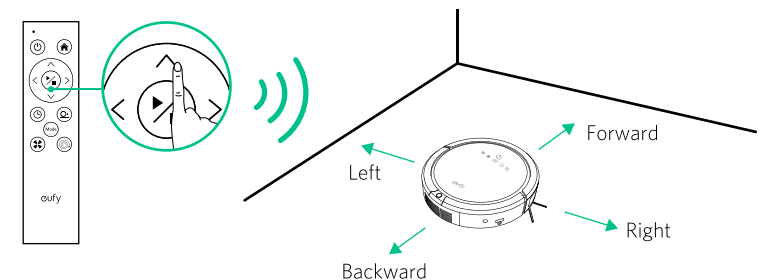

Time Setting

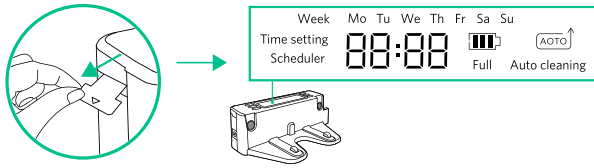

<p>Week Mo Time setting 00:00</p>	Press time .
<p>Week Mo Time setting 12:00</p>	Press hour repeatedly.
<p>Week Mo Time setting 12:34</p>	Press min repeatedly.
<p>Week Th Time setting 12:34</p>	Press week repeatedly to cycle through days.
<p>Week Th Time setting 12:34</p>	Press time again to save the setting.

Any scheduled cleaning will be activated based on the time on the Charging Base. You must set the time before setting scheduled cleaning.

Scheduled Cleaning

Scheduled cleaning is only performed when RoboVac is already docked with the Charging Base.

<p>Week Mo Tu We Th Fr Sa Su Scheduler - - : - -</p>	Press .
<p>Week Mo Tu We Th Fr Sa Su Scheduler 22:00</p>	Press hour repeatedly.
<p>Week Mo Tu We Th Fr Sa Su Scheduler 22:30</p>	Press min repeatedly.

Press **week** to show Mo, press **week** again to select it, or leave it flashing for 8 seconds, when it will switch to Tu automatically. Repeat the process until you've selected the desired days.

Press again to save the setting.

Use the Sonic Wall

Sonic Wall creates an invisible barrier that RoboVac cannot cross.

- Slide the power switch on the back of the Sonic Wall to ON position.
- Place the Sonic Wall in front of the area you want to block access.

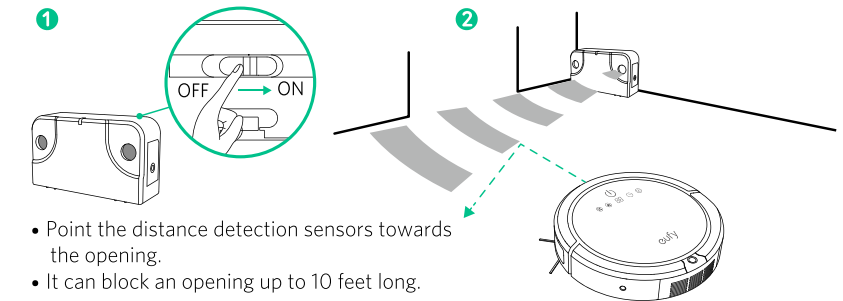

- The Sonic Wall will enter standby mode when RoboVac is turned off, and active automatically when RoboVac starts working.
- Do not install the Sonic Wall near the Charging Base, it may interrupt RoboVac's auto charging.

Charge the Sonic Wall

Two rechargeable batteries are installed in the Sonic Wall, you can charge them directly by the Charging Base.

- Slide out the charging plug on the left side of the Charging Base.
- Insert the charging plug into the socket on the Sonic Wall.

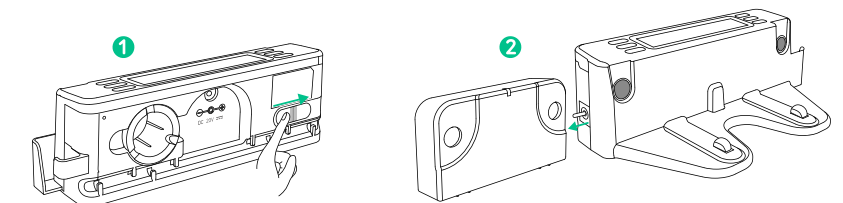

LED indicator status	
Flashing blue	Battery low / Charging
Steady blue	Working / Fully charged
Off	Power off / Standby mode



When the batteries are worn out, RoboVac will pass through the Sonic Wall.

Cleaning and Maintenance



- Always turn off the main power switch on the bottom of RoboVac before maintenance.
- Do not expose the motor part to any liquids.

Clean the Dust Collector and Filter

- 1 Turn off the main power switch on the bottom of RoboVac.
- 2 Press the dust collector release button to pull the dust collector out.
- 3 Press the separation button on the side of the dust collector to open it.

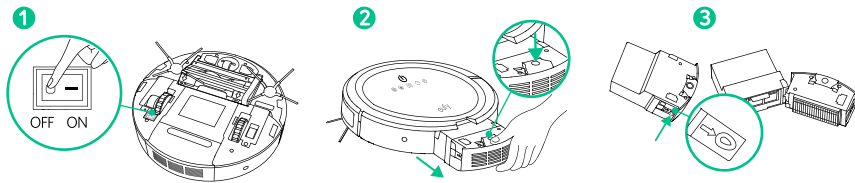

- 4 Separate the dust collector and the motor part.
- 5 Remove the filter and the filter cover.
- 6 Clean the dust collector, filter and filter cover with a cleaning brush or under running water.

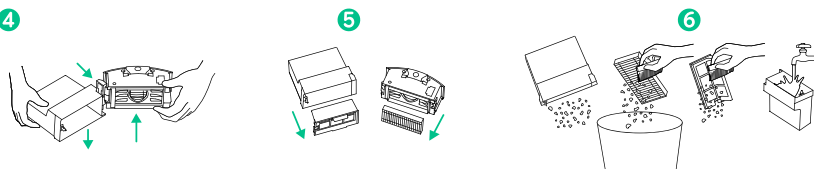

- 7 Reassemble the filter and filter cover.
- 8 Snap the dust collector back into motor part and close it.
- 9 Install the dust collector into the main unit.

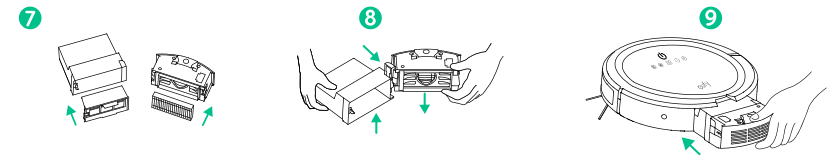

- After cleaning, air-dry the dust collector, filter and filter cover thoroughly before reassembling.
- Empty the dust collector and clean the filter after every use.

Clean the Rolling Brush



Do not attempt to put your fingers inside the brush cleaning tool, it may scratch your fingers.

- 1 Turn off the main power switch on the bottom of RoboVac.
- 2 Lift the brush guard up by pulling the fixing hooks as shown.
- 3 Take the rolling brush out.
- 4 Clean the brush with the provided brush cleaning tool or a vacuum cleaner.
- 5 Reinstall the brush by seating the protruded end first then clicking into place.
- 6 Press down and close the brush guard until it snaps into place.

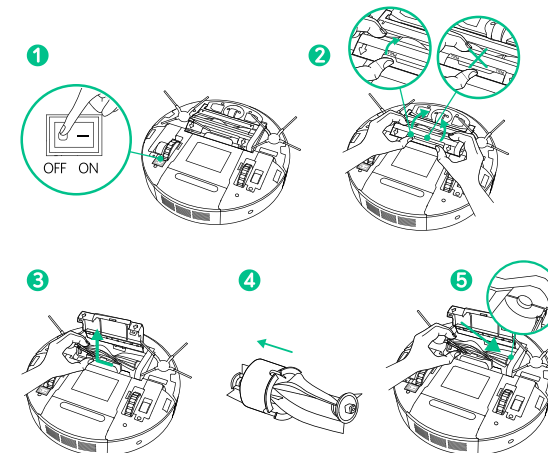

Do not attempt to pull the central part of the brush guard, it may cause critical damage to the device.



Be careful not to trap the side brush when closing the brush guard.

Clean the Sensors and Charging Pins

To maintain best performance, clean the drop sensors and charging pins regularly.

- 1 Turn off the main power switch on the bottom of RoboVac.
- 2 Dust off the drop sensors and charging contact pins using a cloth or cleaning brush.

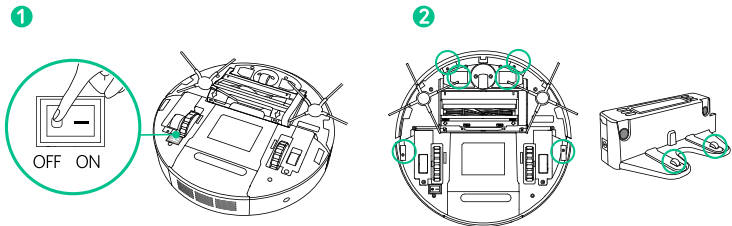

Clean the Side Brushes



Avoid pulling the side brushes unless hair or string is wrapped between the main unit and the side brush.

Foreign substances such as hair can easily adhere to the side brush, make sure to clean it regularly.

- 1 Turn off the main power switch on the bottom of RoboVac.
- 2 Use a cloth damp with warm water to remove dust from the brushes or to gently reshape them.

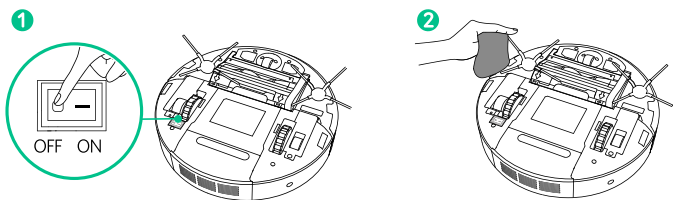

Use the side brushes only when they are completely dry.

Replace the Side Brushes

The side brush may become bent or damaged after using for a period of time, follow the steps below to replace it.

- 1 Turn off the main power switch on the bottom of RoboVac.
- 2 Pull off the old side brush.
- 3 Snap a new one into place.

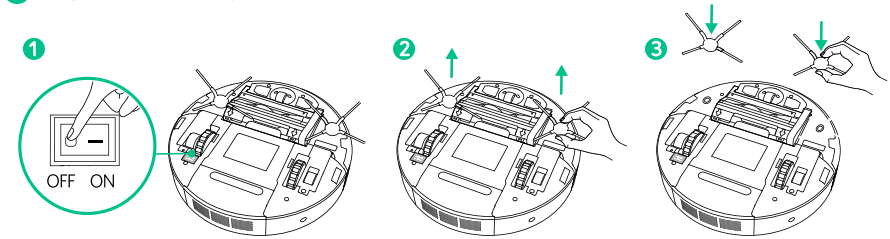

Additional Information

Remove/Install RoboVac's Battery

- 1 Turn off the main power switch on the bottom of RoboVac.
- 2 Take out the dust collector and flip RoboVac over.
- 3 Gently pull up the hooks as shown, the battery will pop up.
- 4 Remove the battery from the main unit.
- 5 Assemble a new battery in the reverse order.

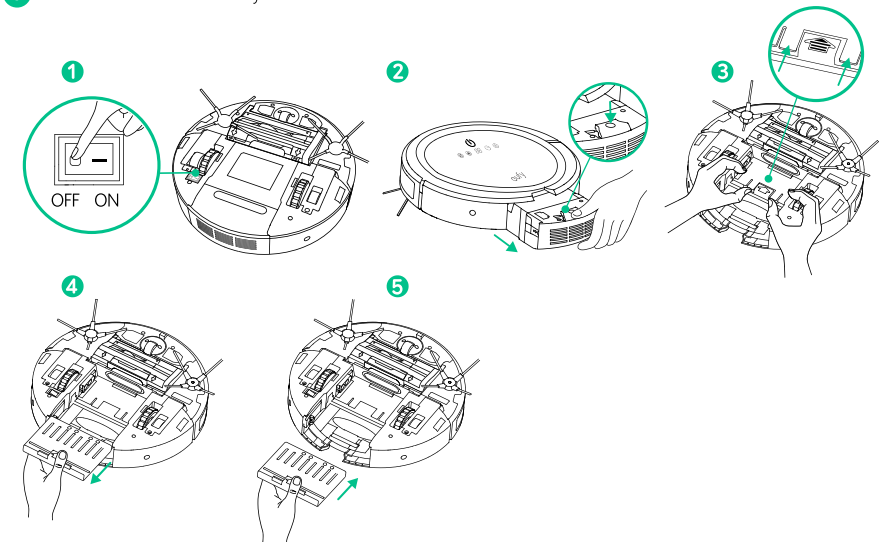



Install Additional Charging Base or Sonic Wall





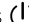

If you want to install an additional Charging Base or Sonic Wall, you need to pair it with your RoboVac before it can be used properly.



For information on how to obtain them, please contact customer service.

RoboVac can work with two Charging Bases and Sonic Walls at the same time.

Pairing a New Charging Base with RoboVac



- 1 Press  on RoboVac to turn it on.
- 2 Press and hold  on RoboVac until you hear two beeps, and the display panel shows "Cd".
- 3 Check RoboVac's status.

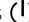

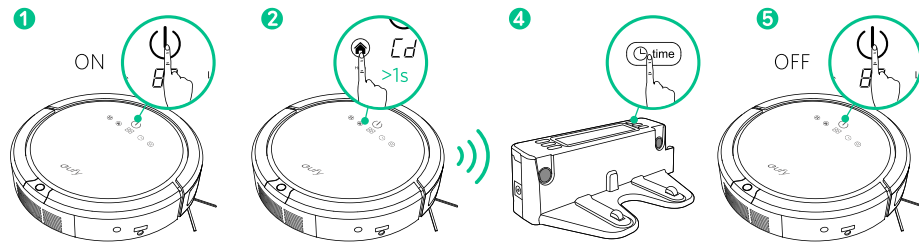

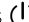

 	Both light up	RoboVac has connected to two Charging Bases already.
 	Either lights up	RoboVac has connected to only one Charging Base.
 	Both are off	RoboVac has not connected to any Charging Base.



- 4 Press  on the Charging Base until you hear two beeps, and either the  or  button lights up.
- 5 Press  on RoboVac to exit pairing mode.



Pairing a New Sonic Wall with RoboVac

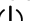

- 1 Press  on RoboVac to turn it on.
- 2 Press and hold  until you hear two beeps, and the display panel shows "Cd".
- 3 Check RoboVac's status.

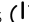
 	Both light up	RoboVac has connected to two Sonic Walls already.
 	Either lights up	RoboVac has connected to only one Sonic Wall.
 	Both are off	RoboVac has not connected to any Sonic Wall.

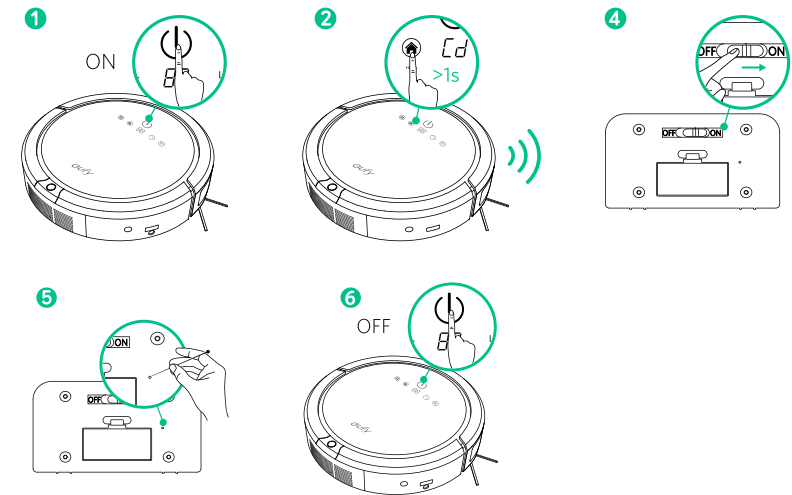
- 4 Power on the Sonic Wall by sliding the power switch to ON position.
- 5 Press and hold the little hole on back of the Sonic Wall with a slender object, such as a straightened paper clip until you hear two beeps and either the  or  button lights up.
- 6 Press  on RoboVac to exit the pairing mode.

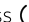

Clearing RoboVac's Pairing Records

- 1 Press  on RoboVac to turn it on.
- 2 Press and hold  until you hear two beeps, and the display panel shows "Cd".
- 3 Press and hold  again until all four buttons light off.

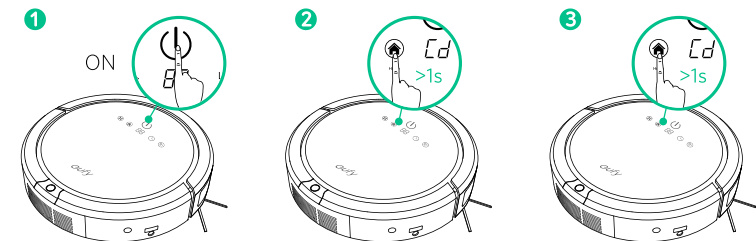

Troubleshooting

Problem	Solutions
RoboVac cannot be activated	<ul style="list-style-type: none"> • Check whether the power switch is turned on. • Check whether the battery has been charged. • Replace the batteries in the remote control. (2 type AAA batteries). • Make sure the remote control is within range. (less than 3m).
RoboVac stops working suddenly	<ul style="list-style-type: none"> • Check whether the power level is too low. • Check whether RoboVac is stuck or trapped on an obstacle.
Suction becomes weak	<ul style="list-style-type: none"> • Check whether any obstructions are blocking the suction inlet. • Empty the dust collector. • Clean the filter.
RoboVac cannot find the Charging Base	<ul style="list-style-type: none"> • Check whether the Charging Base is plugged into the outlet. • Remove objects within 1m to the right and left side and within 2m to the front. • Dust off the charging contact pins with a dry cloth. • Ensure the Sonic Wall is not installed too close to the Charging Base.
RoboVac passes through the Sonic Wall	<ul style="list-style-type: none"> • Check whether the Sonic Wall is turned on. • Ensure batteries are recharged.
The rolling brush does not rotate	<ul style="list-style-type: none"> • Clean the rolling brush. • Check whether the rolling brush has been installed properly.
RoboVac's movements or travel path are abnormal	<ul style="list-style-type: none"> • Clean the sensors carefully with a dry cloth. • Restart Robovac by turning the power switch off and on.



Error codes troubleshooting

Error code	Cause	Solution
E1	<ul style="list-style-type: none"> • RoboVac's drop sensors are dirty. • RoboVac gets stuck or trapped while cleaning. 	<ul style="list-style-type: none"> • Clean the drop sensors with a dry cloth. • Turn off RoboVac and restart in a new location.
E2	RoboVac cannot be charged properly.	Make sure RoboVac's battery is installed properly.
E3	RoboVac's bumper is stuck.	Tap RoboVac's bumper several times to dislodge any debris that may be trapped underneath.

E4	RoboVac's battery is over heated.	Turn off RoboVac and let it cool down sufficiently, then try charging again.
E5	RoboVac's left wheel is stuck.	Turn off RoboVac and remove any hair or debris from the left wheel.
E6	RoboVac's right wheel is stuck.	Turn off RoboVac and remove any hair or debris from the right wheel.
E7	RoboVac's side brush is stuck.	Turn off RoboVac and remove any hair or debris from the side brush.
E8	RoboVac's rolling brush is stuck.	Turn off RoboVac and remove any hair or debris from the rolling brush.
E9	RoboVac's suction fan is stuck.	Turn off RoboVac and remove any hair or debris from the suction fan.

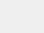
Specifications

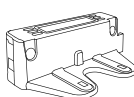
	Product Model	T2101
	Input	20 V  1 A
	Power Consumption	25 W
	Battery Type	DC 14.4 V Li-ion 6700 mAh
	Dust collector capacity	0.4 L
	Cleaning Time	Max 200 mins
	Charging Time	300 mins

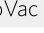
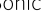
	Input	20 V  1 A
	Output for RoboVac	20 V  1 A
	Output for the Sonic Wall	3.6 V  0.35 A

	Input	3.6 V  0.35 A
	Battery	DC 1.2 V Ni-Mh 1.44 Wh

Notice



The symbol on the product or its packaging indicates:

Do not dispose of electrical appliances as unsorted municipal waste, use separate collection facilities. Contact your local authority for information regarding the collection systems available. If electrical appliances are disposed of in landfills or dumps, hazardous substances can leak into the groundwater and get into the food chain, damaging your health and well-being. When replacing old appliances with new ones, the retailer is legally obliged to take back your old appliance for disposal at least free of charge.

FCC Statement

This device complies with Part 15 of the FCC Rules. Operation is subject to the following two conditions: (1) This device may not cause harmful interference, and (2) this device must accept any interference received, including interference that may cause undesired operation.

Warning: Changes or modifications not expressly approved by the party responsible for compliance could void the user's authority to operate the equipment.

Note: This equipment has been tested and found to comply with the limits for a Class B digital device, pursuant to Part 15 of the FCC Rules. These limits are designed to provide reasonable protection against harmful interference in a residential installation.

This equipment generates uses and can radiate radio frequency energy and, if not installed and used in accordance with the instructions, may cause harmful interference to radio communications. However, there is no guarantee that interference will not occur in a particular installation. If this equipment does cause harmful interference to radio or television reception, which can be determined by turning the equipment off and on, the user is encouraged to try to correct the interference by one or more of the following measures: (1) Reorient or relocate the receiving antenna. (2) Increase the separation between the equipment and receiver. (3) Connect the equipment into an outlet on a circuit different from that to which the receiver is connected. (4) Consult the dealer or an experienced radio / TV technician for help.

Customer Service



12 months Limited Warranty



Lifetime Technical Support



support@eufylife.com



1-800-988-7973(US) Mon-Fri 9am-5pm(PST)



@EufyOfficial



@EufyOfficial



@EufyOfficial



@EufyOfficial